



THE SOURCE

CASE STUDY

ABOUT THE SOURCE

The Source is committed to providing a safe, clean, comfortable, respectful, and compassionate environment, where patients and customers can easily and affordably obtain a host of wellness products and services. They help patients through the healing process with a variety of wellness programs, education and advocacy, positive encouragement, and mutual respect.

The Source came to Pipp wanting to maximize their dispensary space and streamline their operations by implementing a storage system that allows them to easily store, access, and move products throughout their facility.

PLANNING

Pipp's team of in-house designers worked with The Source to develop a custom floor-plan that would optimize the layout of their backroom, while maximizing their storage capacity and product organization. One of the top priorities for The Source was to create a secure and efficient working environment that would keep their employees, customers, and products safe.

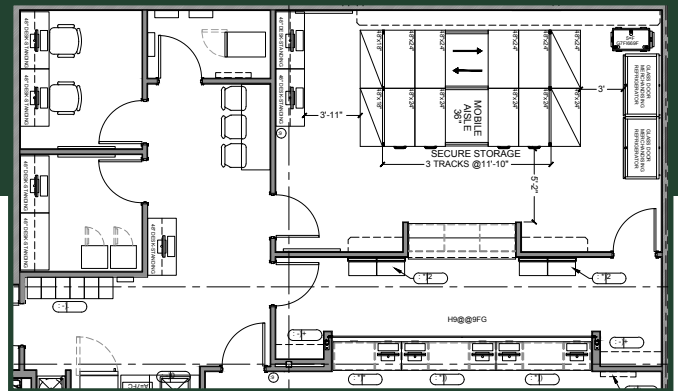

THE GOAL



MAXIMIZE

storage space within a set footprint with mobile shelving



MOVEMENT

of aisles for a better workflow



INCREASED SAFETY & SECURITY

for employees and inventory



THE SOLUTION

By implementing Pipp's Dispensary Mobile Storage Systems, The Source was able to increase the square footage of their storage capacity by 61% compared to their previous stationary layout. They were also able to optimize their workflows with the addition of mobile aisles, which allow employees to quickly, easily, and safely access products from the different shelves and levels, while securely locking away the products in the aisles that are not currently being used.



THE RESULTS

61% INCREASE
in storage capacity square footage



EFFICIENT WORK SPACE
with movable aisles, easy access,
and organized bin storage



SECURED STORAGE
locks away products in closed aisles

